

THE "YANKEE"™ SPIRAL RATCHET SCREWDRIVER

HOW TO USE

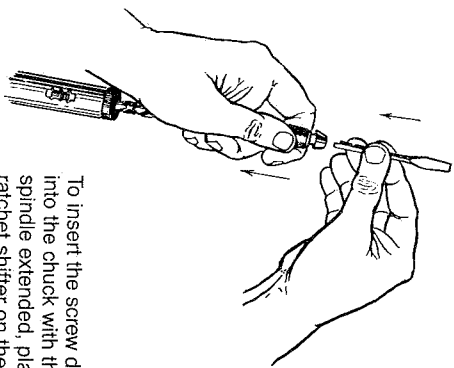

To insert the screw driver bit into the chuck with the spiral spindle extended, place the ratchet shifter on the center position. Pull the chuck sleeve down. Insert the bit. Turn the bit until you feel it is seated. Release the chuck sleeve.

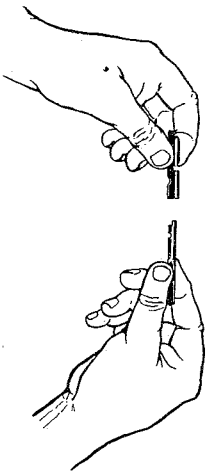

With the drill points and chuck adaptor the spiral ratchet screw driver becomes an automatic push drill. A drill point is inserted into the chuck adaptor. Turn the drill point until you feel it is seated. The two assembled pieces are then placed in the chuck in the same manner as a screw driver bit.

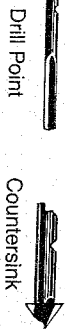

There are eight drill points, sizes $\frac{1}{16}$ " to $\frac{1}{8}$ ". The countersink also fits the screw driver chuck.

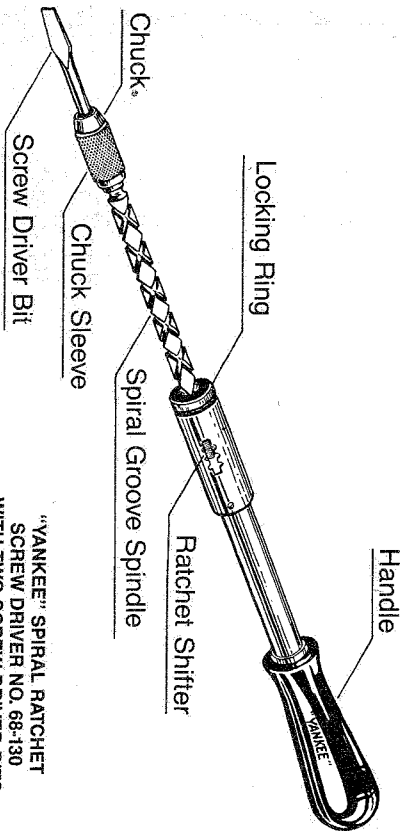

"YANKEE" SPIRAL RATCHET SCREW DRIVER NO. 68-130 WITH TWO SCREW DRIVER BITS

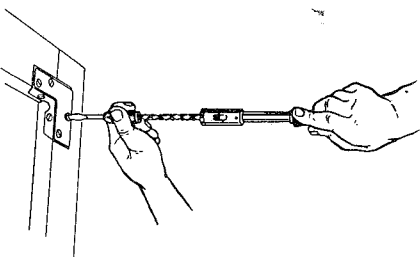

The Yankee spiral ratchet screw driver is most useful for the rapid driving or drawing of screws or for use in awkward places. It is especially practical in repetitive production work in industry. It can be steadied by holding the revolving chuck sleeve with the fingers of the left hand.

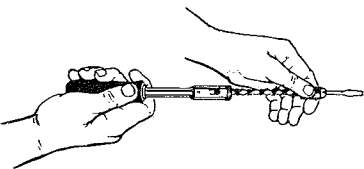

To drive screws or drill holes with quick return spiral ratchet action, set the ratchet shifter on the position nearest to the chuck.



To use as a long rigid screw driver, without spiral or ratchet action, set the ratchet shifter on the center position.



To draw screws with quick return spiral ratchet action, set the ratchet shifter on the position nearest the handle.

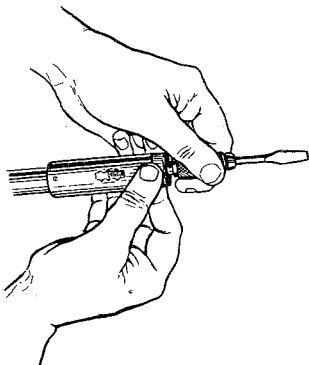

To use as a ratchet screw driver draw the spindle in, then turn the locking ring to the left to lock it. Vary the shifter position to change the ratchet action. To release the spiral spindle safely, hold it by the chuck while turning the locking ring to the right, so spindle will not fly out.

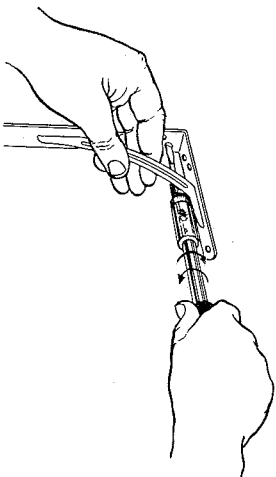

As a ratchet screw driver, the screw is driven or drawn by turning the hand right and left. The left hand is free to hold the work, after the screw is started.



Phillips Screw Driver Bit
The Phillips screw driver bits are accessories that add to the usefulness of this tool.

EDUCATIONAL DEPARTMENT
CHART NO. 27
BY R.O. REGER



WORK SAFELY WITH TOOLS BY WEARING SAFETY GOGGLES

PRINTED IN U.S.A.