

INSTRUCTION MANUAL

Cordless Screwdriver

Rechargeable • 4.8 volt • 2 Position

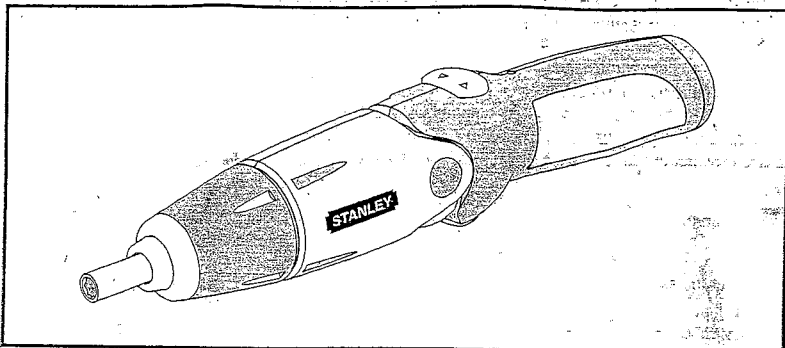

USA Customer Service
Toll free Number: 1-800-262-2161
<http://www.Stanleyworks.com>

GENERAL SAFETY RULES FOR YOUR STANLEY BATTERY OPERATED CORDLESS SCREWDRIVER

Please save these instructions for future reference.

 Wear Safety Glasses
Utilice Gafas Protectoras
Portez des Lunettes de Sécurité

GENERAL SAFETY RULES FOR ALL BATTERY OPERATED TOOLS

Failure to follow all instructions listed below, may result in electric shock, fire and / or serious personal injury.

WORK AREA

- Keep your work area clean and well lit. Cluttered benches and dark areas invite accidents.
- Do not operate power tools in explosive atmospheres, such as in the presence of flammable liquids, gasses, or dust. Power tools create sparks, which may ignite the dust or fumes.
- Keep bystanders, children and visitors away while operating a power tool. Distractions can cause you to lose control.

ELECTRICAL SAFETY

Do not abuse the cord. Never use the cord to carry the tool. Keep cord away from heat, oil, sharp edges, or moving parts. Replace damaged cords immediately. Damaged cords may create a fire.

Applies only to tools with separate battery pack.

A battery-operated tool with integral batteries or a separate battery pack must be recharged only with the specified charger for the battery. A charger that may be suitable for one type of battery may create a risk of fire when used with another battery.

Use battery operated tool only with the specifically designated battery pack. Use of any other batteries may create a risk of fire.

PERSONAL SAFETY

Stay alert, watch what you are doing, and use common sense when operating a power tool. Do not use tool while tired or under the influence of drugs, alcohol, or medication. A moment of inattention while operating power tools may result in serious person injury.

Dress properly. Do not wear loose clothing or jewelry. Contain long hair. Keep your hair, clothing, and gloves away from moving parts. Loose clothes, jewelry, or long hair can be caught in moving parts.

Avoid accidental starting. Be sure switch is in the locked or off position before inserting battery pack. Carrying tools with your finger on the switch or inserting the battery pack into a tool with the switch on invites accidents.

Remove adjusting keys or wrenches before turning the tool on. A wrench or a key that is left attached to a rotating part of the tool may result in personal injury.

Do not overreach. Keep proper footing and balance at all times. Proper footing and balance enable better control of the tool in unexpected situations.

Use safety equipment. Always wear eye protection. Dust mask, non-skid safety shoes, hard hat, or hearing protection must be used for appropriate conditions.

ADDITIONAL USE AND CARE

- Do not force tool. Use the correct tool for your application. The correct tool will do the job better safer at the rate for which it is designed.
- Do not use tool if switch does not turn it on or off. A tool that cannot be controlled with the switch is dangerous and must be repaired.
- Disconnect battery pack from tool or place the switch in the locked or off position before making adjustments, changing accessories, or storing the tool. Such preventative safety measures reduce risk of starting the tool accidentally.
- Store idle tools out of the reach of children and other untrained persons. Tools are dangerous in hands of untrained users.
- When battery pack is not in use, keep it away from other metal objects like: paper clips, coins, keys, nails, screws, or other small metal objects that can make a connection from one terminal to another. Shorting the battery terminals together may cause sparks, burns, or a fire.
- Maintain tools with care. Keep cutting tools sharp and clean. Properly maintained tools, with sharp cutting edges are less likely to bind and are easier to control.
- Check for misalignment or binding of moving parts, breakage of parts, and any other condition that may affect the tools operation. If damaged, have the tool serviced before using. Many accidents are caused by poorly maintained tools.
- Use only accessories that are recommended by the manufacturer for your model. Accessories that may be suitable for one tool may create a risk of injury when used on another tool.

SERVICE

- Tool service must be performed only by qualified repair personnel. Service or maintenance performed by unqualified personnel may result in a risk of injury.
- When servicing a tool, use only identical replacement parts. Follow instructions in the Maintenance Section of this manual. Use of unauthorized parts or failure to follow Maintenance Instructions may create a risk of shock or injury.

SPECIFIC SAFETY RULES

- Hold tool by insulated gripping surfaces when performing an operation where the cutting tool may contact hidden wiring. Contact with a "live" wire will also make exposed metal parts of the tool "live" and shock the operator.

The label on your tool may include the following symbols:

V.....volts	A.....amperes
Hz..... hertz	W..... watts
min..... minutes	~.....alternating current
—..... direct current	n ₀no load speed
□..... Class II Construction	⊕..... earthing terminal
⚠..... safety alert symbol/min.....revolutions or reciprocations per minute

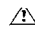
 **WARNING:** Some dust created by power sanding, sawing, grinding, drilling, and other construction activities contains chemicals known to cause cancer, birth defects or other reproductive harm. Some examples of these chemicals are:

- lead from lead-based paints
- crystalline silica from bricks and cement and other masonry products
- arsenic and chromium from chemically-treated lumber. (CCA)

Your risk from these exposures varies, depending on how often you do this type of work. To reduce your exposure to these chemicals: work in a well ventilated area, and work with approved safety equipment, such as those dust masks that are specially designed to filter out microscopic particles.

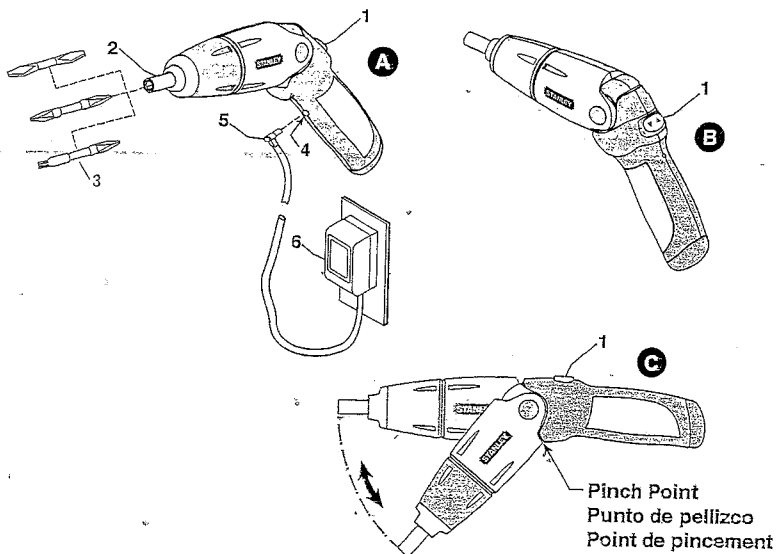

FEATURES (Figure A)

- On/Off switch with forward/reverse function
- Bit holder
- Bit (3 supplied)
- Charger socket
- Charger adapter plug

CHARGING THE SCREWDRIVER

Before attempting to charge your screwdriver, thoroughly read all of the safety instructions. To charge your screwdriver, follow the steps below.

1. Plug the output cord of the charger (5) into the socket in the bottom of the screwdriver handle as shown in Figure (A).
2. Plug the charger into any standard electrical outlet.

CHARGING NOTES

NOTE: The tool was sent from the factory in an uncharged condition. Before attempting to use it, it must be charged for 14 hours.

1. Charger will work best at normal room temperature.
2. The charger plug and the tool handle may become warm while charging. This is normal and does not indicate a problem.
3. The tool can be left on charge for as long as you desire. A minimum charge time of 14 hours is required to recharge a completely discharged tool.
4. For most fix up jobs, a charge of 8 to 10 hours will be adequate.

⚠ WARNING: To avoid injury or property damage, disconnect the charger from the outlet first before disconnecting the screwdriver from the charger.

OPERATING INSTRUCTIONS

Removing and Installing the Bits

- To install a screwdriver bit (3) Fig. A, simply insert it into the cavity in the spindle (2) until it snaps into place. To remove the bit, pull it straight out. If bit does not fit into spindle, rotate the bit and re-insert it.

ADJUSTING THE HANDLE

- The screwdriver can be set to two different positions as shown in Fig. C.

To adjust the handle, hold both halves of the driver and "snap" the handle from either the straight position to the pistol position or from the pistol position to the straight position. The spring loaded pivot will securely "lock" your rechargeable screwdriver in two positions.

NOTE: To avoid being pinched, grasp the handle below the pinch point shown in Fig. C.

TO OPERATE THE TOOL

- Push on/off switch (1) in Fig. B to the right for forward, a clockwise rotation, and to the left for reverse, a counter-clockwise rotation.
- If it is desired to use tool in manual mode, the spindle will lock automatically when not in use.

MAINTENANCE

Use mild soap and damp cloth to clean the tool. Never allow any liquid to get inside the tool and never allow any part of the tool to become immersed in a liquid.

LUBRICATION

This Stanley tool is permanently lubricated at the factory and is ready for use.

THE RBRC™ SEAL

The RBRC™ (Rechargeable battery Recycling Corporation) Seal on the nickel-cadmium battery (or battery pack) indicates that the costs to recycle the battery (or battery pack) at the end of its useful life have already been paid by The Stanley Works. In some areas, it is illegal to place spent nickel-cadmium batteries in the trash or municipal solid waste stream



RBRC in cooperation with The Stanley Works and other battery users, has established programs in the United States and Canada to facilitate the collection of spent nickel-cadmium batteries. Help protect our environment and conserve natural resources by returning the spent nickel-cadmium battery to an authorized local retailer for recycling. You may also contact your local recycling center for information on where to drop off the spent battery, or call 1-800-8-BATTERY.

BATTERY PACK REMOVAL

IMPORTANT: This tool is designed for easy disassembly for the purpose of battery pack removal. It is not designed to be re-assembled by the consumer. Before attempting to disassemble this tool, turn it on and run it in either direction until it stops to ensure a complete discharge of the battery pack. To disassemble the tool, pry off the two yellow pivot caps and remove all the screws in the side of the tool body. Take the two body halves apart and you will find the battery pack. Lift the battery pack out and pull off the terminal clips.

LIMITED WARRANTY

Stanley warrants this product to the original purchaser for a period of one (1) year against deficiencies in material and workmanship. This LIMITED WARRANTY does not cover products that are improperly used, abused, altered or repaired. Deficient products will be replaced or repaired. Please call 1-800-262-2161 for more information or return instructions.

THIS LIMITED WARRANTY IS GIVEN IN LIEU OF ALL OTHERS INCLUDING THE IMPLIED WARRANTY OF MERCHANTABILITY AND FITNESS FOR A PARTICULAR PURPOSE AND EXCLUDES ALL INCIDENTAL OR CONSEQUENTIAL DAMAGES. Some states do not allow limitations on how long an implied warranty lasts or the exclusion or limitation of incidental or consequential damages, so these limitations may not apply to you. This LIMITED WARRANTY gives you specific legal rights that may vary from state to state.



Wear Safety Glasses
Utilice Gafas Protectoras
Portez des Lunettes de Sécurité

©2003 THE STANLEY WORKS
New Britain, CT 06053 U.S.A.
www.stanleyworks.com

STANLEY
®